

**vtech**<sup>®</sup>  
Baby

# User's Manual

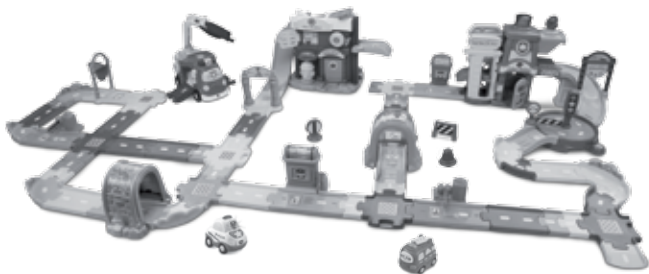

## Toot-Toot Drivers Super City



© 2015 VTech  
Printed in China  
91-003117-002 UK

**VTech understands that a child's needs and abilities change as they grow and with that in mind we develop our toys to teach and entertain at just the right level...**

## **vtech** Baby

**Toys that will stimulate their interest in different textures, sounds and colours**

### **I am...**

...responding to colours, sounds and textures

...understanding cause and effect

...learning to touch, reach, grasp, sit-up, crawl and toddle

*Birth-36 months*



## **Pre-School**

**Interactive toys to develop their imagination and encourage language development**

### **I want...**

...to get ready for school by starting to learn the alphabet and counting

...my learning to be as fun, easy and exciting as can be

...to show my creativity with drawing and music so my whole brain develops

*3-6 years*



## **Electronic Learning Computers**

**Cool, aspirational and inspiring computers for curriculum related learning**

### **I need...**

...challenging activities that can keep pace with my growing mind

...intelligent technology that adapts to my level of learning

...National Curriculum based content to support what I'm learning at school

*4-10 years*



To learn more about this and other VTech® products, visit [www.vtech.co.uk](http://www.vtech.co.uk)

# INTRODUCTION

Thank you for purchasing the **VTech® Toot-Toot Drivers Super City** learning toy!

Hurry to the emergency with **Toot-Toot Drivers Super City** play set! Featuring a fire station, police station and a variety of tracks and accessories this play set is perfect for creating an entire city!

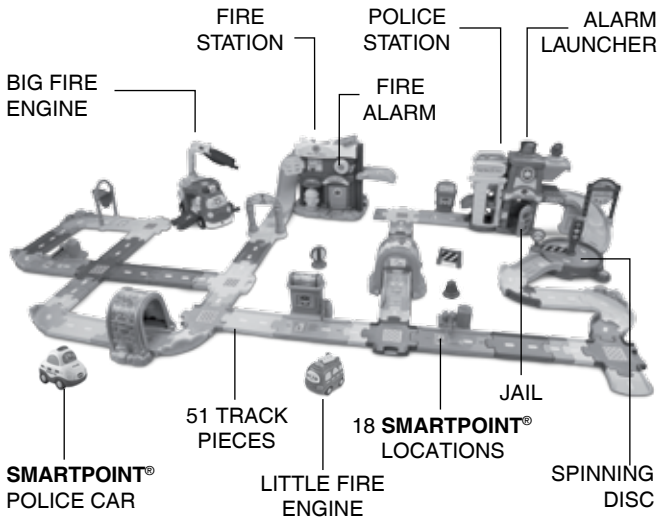

# INCLUDED IN THIS PACKAGE

- One user's manual
- One sheet of labels



One traffic cone



One roadblock



One small track



One **SmartPoint**<sup>®</sup> exit track



One spinning disc



One big curved track



One gate



One traffic light



One track support



One large lift bracket



One small lift bracket



One police station building



One **SmartPoint**<sup>®</sup> police station lift



One **SmartPoint**<sup>®</sup> patrol booth track piece



One patrol booth



One **SmartPoint**<sup>®</sup> police car

INCLUDED IN THIS PACKAGE



Two play pieces



One spinner



One gate archway



**SmartPoint®**  
spinning gate track



One big fire engine



One non-electronic fire engine



One fire station building



One fire station base



One **SmartPoint®**  
fire station lift



One fire hydrant



One curved ramp piece



One straight ramp piece



Two **SmartPoint®**  
gate tracks



One **SmartPoint®**  
car wash



One **SmartPoint®**  
toll booth

INCLUDED IN THIS PACKAGE



Ten 3/4 straight tracks



One 1/4 straight track, male



Thirteen 1/4 straight tracks



Four 90-degree tracks, male



Two tunnels



Two **SmartPoint**<sup>®</sup> tunnel tracks



One 60-degree track, male



Two 90-degree tracks, female



Eight cross tracks



One end track



Two 60-degree tracks, female



One 1/4 straight track, female

**WARNING:**

All packing materials, such as tape, plastic sheets, packaging locks and tags are not part of this toy, and should be discarded for your child's safety.

**NOTE:**

Please keep this user's manual as it contains important information.

# GETTING STARTED

## BATTERY INSTALLATION

1. Make sure the unit is turned **OFF**.
2. Locate the battery cover on the bottom of the police car. Use a screwdriver to loosen the screw.
3. Install 2 new 'AAA' (AM-4/LR03) batteries following the diagram inside the battery box. (The use of new alkaline batteries is recommended for maximum performance.)
4. Replace the battery cover and tighten the screw to secure.

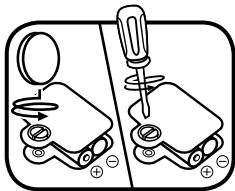

## BATTERY NOTICE

- Use new alkaline batteries for maximum performance.
- Use only batteries of the same or equivalent type as recommended.
- Do not mix different types of batteries: alkaline, standard (carbon-zinc) or rechargeable (Ni-Cd, Ni-MH), or new and used batteries.
- Do not use damaged batteries.
- Insert batteries with the correct polarity.
- Do not short-circuit the battery terminals.
- Remove exhausted batteries from the toy.
- Remove batteries during long periods of non-use.
- Do not dispose of batteries in fire.
- Do not charge non-rechargeable batteries.
- Remove rechargeable batteries from the toy before charging (if removable).
- Rechargeable batteries are only to be charged under adult supervision.

## Disposal of batteries and product



The crossed-out wheeled bin symbols on products and batteries, or on their respective packaging, indicates they must not be disposed of in domestic waste as they contain substances that can be damaging to the environment and human health.



The chemical symbols Hg, Cd or Pb, where marked, indicate that the battery contains more than the specified value of mercury (Hg), cadmium (Cd) or lead (Pb) set out in Battery Directive (2006/66/EC).

The solid bar indicates that the product was placed on the market after 13th August, 2005.

Help protect the environment by disposing of your product or batteries responsibly.

For more information, please visit:

[www.recycle-more.co.uk](http://www.recycle-more.co.uk)

[www.recyclenow.com](http://www.recyclenow.com)



Please stick the labels to the play set securely as indicated below:

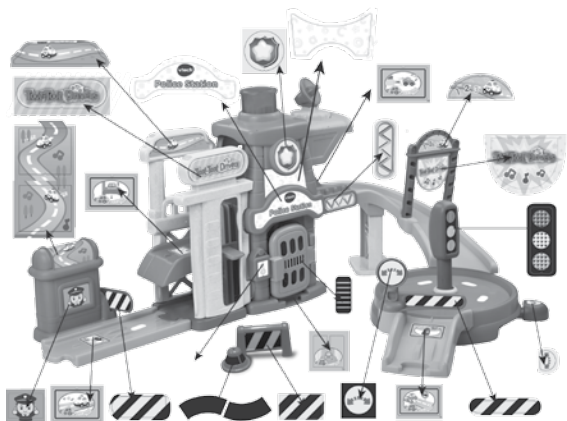

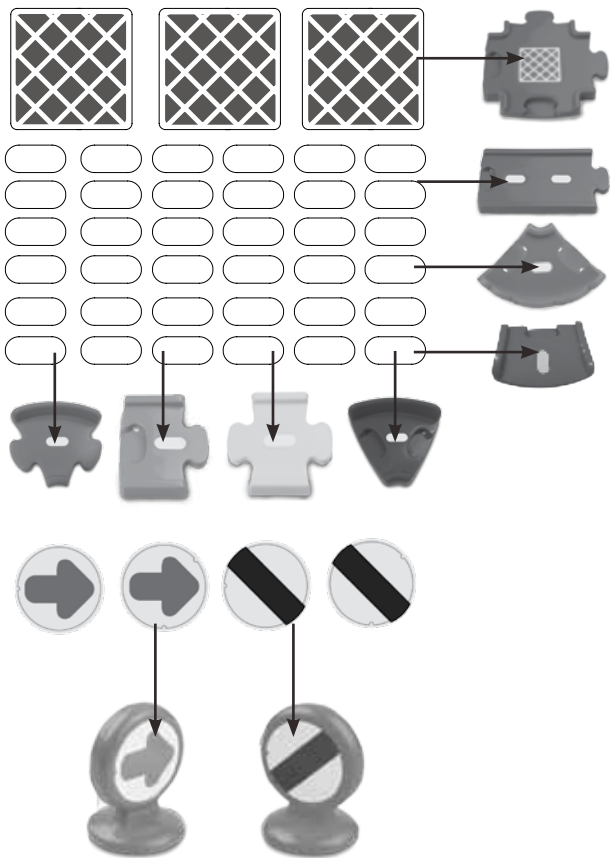

# ASSEMBLY INSTRUCTIONS

With the VTech® Toot-Toot Drivers Super City, safety comes first. To ensure your child's safety, adult assembly is required.

To assemble your **Toot-Toot Drivers Super City** play set, please follow the instructions below:

- 1. Assemble the police station:** First slide the lift into the groove on the side of the police station building, then attach the large lift bracket behind the lift and the small lift bracket in front. Finally, attach the two brackets to the small track piece to secure.
- 2. Assemble the patrol booth:**

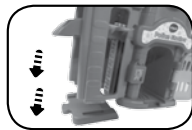
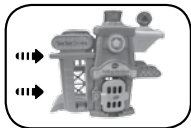
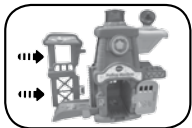
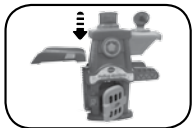

Attach the patrol booth track to the small track piece on the police station. Then, insert the patrol booth piece onto the notch on the side of the track.

- 3. Assemble the curved track:** Attach the track support to the big curved track. Then, attach the curved track to the police station as shown below. Insert the gate into the big curved track.

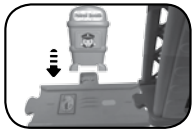

4. **Assemble the spinning disc:** Put the traffic light into the hole at the centre of the spinning disc and attach the disc to the bottom of the big curved track. Attach the exit track to the spinning disc.

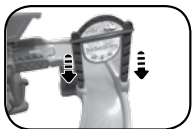
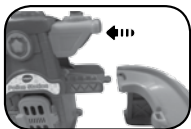

## POLICE CAR FEATURES

### 1. ON/OFF SWITCH

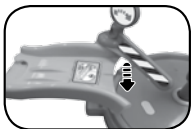

5. **Assemble the spinning gate:** Locate the spinner and insert it into the gate archway as shown. Place the fully assembled spinning gate onto the spinning gate track piece.

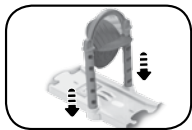

6. **Assemble the fire station:** Slide the lift onto the groove on the side of the fire station building. Then, attach the fire station building to the station base as shown.



7. **Attach the fire hydrant:** Attach the fire hydrant to the fire station base as shown. You will hear a “click” sound when it locks into place.



8. **Assemble the ramp:** Connect the curved and straight ramp pieces together. Attach the curved ramp piece to the top of the fire station.

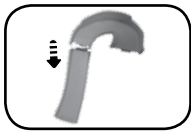

9. **Assemble the tunnels:** Attach the tunnel to the **SmartPoint**® tunnel track. You will hear a “click” sound to indicate the track is secure.

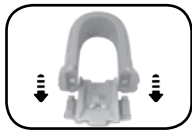

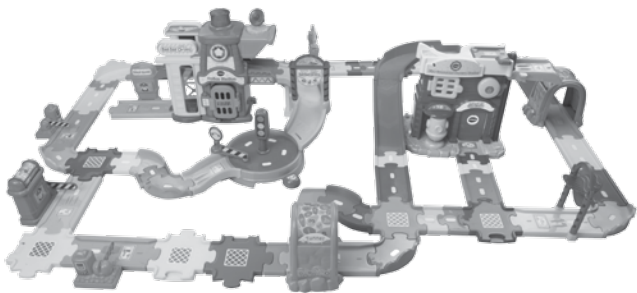
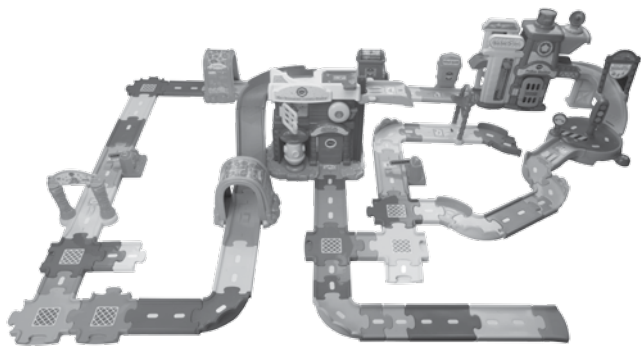

Once you've completed the above steps, you are ready to play! You can connect these pieces to the other included track pieces in a variety of ways.



# POLICE CAR ACTIVITIES

## 1. ON/OFF SWITCH

To turn the unit **ON**, slide the **ON/OFF SWITCH** on the police car to the **ON** (  ) position. To turn the unit **OFF**, slide the **ON/OFF SWITCH** to the **OFF** (  ) position.

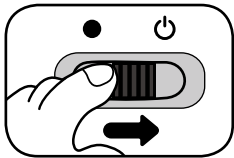

## 2. AUTOMATIC SHUT-OFF

To preserve battery life, the **VTech® Police Car** will automatically power-down after approximately 60 seconds without input. The unit can only be turned on again by pressing the light-up button or pushing the police car quickly.

# POLICE CAR ACTIVITIES

1. Slide the **ON/OFF SWITCH** to turn the unit **ON**. You will hear police car sounds, a song and a phrase. The light will flash with the sounds.
2. Press the **LIGHT-UP BUTTON** to hear police car songs and phrases. The light will flash with the sounds.

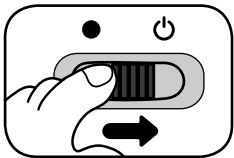

3. Push the police car to hear fun sounds and melodies. While the melody is playing, push the police car again to add in fun sounds on top of the melody. The light will flash with the sounds.



4. For added fun, the police car interacts with other play sets. Simply roll the police car over one of the play set's **SmartPoint**<sup>®</sup> locations to see the police car's light flash and to hear greetings, fun sounds, short tunes and sing-along songs (additional play sets sold separately).

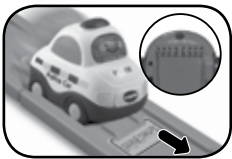

## SUPER CITY ACTIVITIES

1. Drive the police car over the eighteen different **SmartPoint**<sup>®</sup> locations to trigger fun sounds, phrases and sing-along songs.
2. Move the car up to the top of the police station or fire station with the **LIFT**.

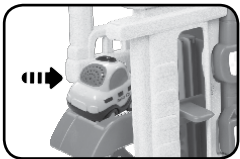



3. From the top of the police station, press the **ALARM LAUNCHER** to launch the police car down the big curved track.

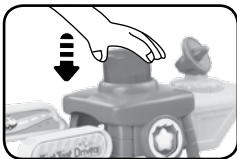

4. Slide the bar on the side of the **SPINNING DISC** to quickly move the police car in a fast-paced chase!



5. Open the **JAIL** gate to put the pretend criminal behind bars!



6. Move the police car through the spinning gate to watch it twirl.

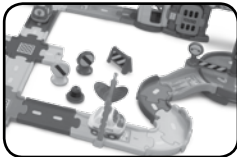

7. Slide the **FIRE ALARM** lever to hear a mechanical alarm sound.

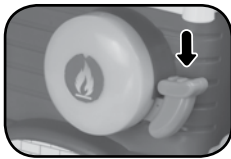

8. Launch the **SmartPoint®** police car down the **FIRE STATION** ramp and pretend to race to an emergency!



9. Load your **SmartPoint®** police car onto the **BIG FIRE ENGINE** to help it get around. Use the ladder to lift up the **SmartPoint®** police car.



10. Press the **BIG FIRE ENGINE'S** button to hear beeping sounds.

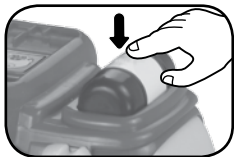

11. Move the fire hose and fire extinguisher on the big fire engine.

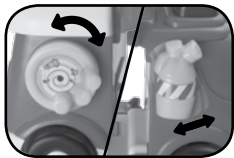

# CARE & MAINTENANCE

1. Keep the unit clean by wiping it with a slightly damp cloth.
2. Keep the unit out of direct sunlight and away from any direct heat source.
3. Remove the batteries when the unit will not be in use for an extended period of time.
4. Do not drop the unit on hard surfaces and do not expose the unit to moisture or water.

# TROUBLESHOOTING

If for some reason the program/activity stops working, please follow these steps:

1. Please turn the unit **OFF**.
2. Interrupt the power supply by removing the batteries.
3. Let the unit stand for a few minutes, then replace the batteries.
4. Turn the unit **ON**. The unit should now be ready to play again.
5. If the product still does not work, replace with an entire set of new batteries.

If the problem persists, please call our Consumer Services Department on 01235 546810 (from UK) or +44 1235 546810 (outside UK) and a service representative will be happy to help you.

## **IMPORTANT NOTE:**

Creating and developing VTech products is accompanied by a responsibility that we take very seriously. We make every effort to ensure the accuracy of the information, which forms the value of our products. However, errors sometimes can occur. It is important for you to know that we stand behind our products and encourage you to call our Consumer Services Department on 01235 546810 (from UK) or +44 1235 546810 (outside UK), with any problems and/or suggestions that you might have. A service representative will be happy to help you.

CLASS 1  
LED PRODUCT

**WARNING:**  
Adult assembly required.



## PRODUCT WARRANTY



Thank you for choosing this quality product from VTech. We hope it will bring many hours of entertainment, imaginative play and learning.

1. The product detailed above is covered by a one year warranty from the date of purchase, against any defects in materials or workmanship.
2. The product may be returned to the place of purchase. Alternatively the product can be returned to VTech Electronics Europe plc (see address below), with proof of purchase, without proof of purchase no replacement will be provided.
3. VTech Electronics Europe plc will examine the product and if it is found to be defective due to faulty materials or workmanship, will replace the product at their discretion.
4. If the product covered by this warranty is damaged due to misuse, modification or unauthorised repair, or because of faulty batteries, battery discharge or incorrect electrical connections, then this warranty becomes void.
5. This warranty is personal to the original purchaser and is not transferable.
6. Breakages to the LCD screen are not covered by the warranty.
7. Returns to VTech Electronics Europe plc should include a cheque or postal order for £1.50 towards the cost of return postage and packaging.
8. Products returned to VTech Electronics Europe plc, should be addressed as follows and packed carefully to avoid damage in transit (Please do not include batteries or adaptor).  
Please include details of the fault together with your name and address.
9. To keep an online record of your warranty, please register your product online at [www.vtech.co.uk/warranty](http://www.vtech.co.uk/warranty)

VTech Electronics Europe plc, c/o Tablogix Limited, 200 Milton Park, Abingdon, Oxon OX14 4TA

**THIS WARRANTY IS OFFERED AS AN EXTRA BENEFIT AND DOES NOT AFFECT CONSUMERS' STATUTORY RIGHTS.**

This warranty is valid for the UK and Eire only. For products purchased outside the UK and Eire, please contact your local distributor or place of purchase.

